

# FOR SALE

## \$ 249,000.00 USD

Panama - Panamá

Panama - Costa del Este

Listing ID: 002393032009

Preconstruction Sale - TURNKEY CONDO-SUITES  
Construction started 2024 and properties will be ready for delivery by the end of 2026 Show unit available for viewing !  
Payment structure is as follows: 10% on signature 10% 6 months from signature 10% 12 months from signature The balance of 70%, bank financing or cash, on delivery with the Occupancy Permission. Apartments available: 53m2 from \$228.500,00 58m2 From \$240.000,00 65m2 from \$274.500,00 Generation Tower is a unique and innovative concept in the most premium location of Panama City, Costa del Este, just steps from Town Centre. Generation Tower will have an administrative hotel management, where you can rent the unit for short- or long-term stays. An ideal place for tourists, executives and people looking for a permanent residence with all the luxuries of a hotel! ...

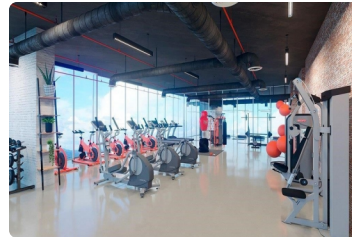
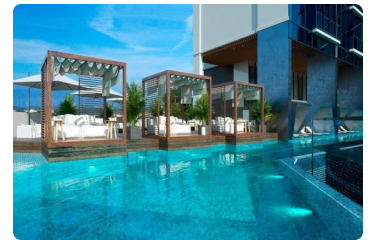
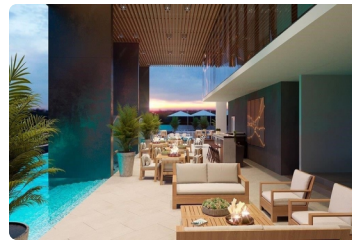

[SEE THIS PROPERTY ON THE MAP](#)



PEDRO ALVARADO

SALES AGENT

507 67044571

[pedro.alvarado@remax-life.com.pa](mailto:pedro.alvarado@remax-life.com.pa)

<http://www.remax-life.com.pa>



RE/MAX LIFE

Oceanía Business Plaza, torre 1000, C. Isaac Hanono Mssri, Panamá, Provincia de Panamá, Panamá

Each office is independently owned and operated